

Name: <u>Reno Savoya</u>		Date: <u>24/02/2018</u>	Event: <u>Dirt Nitro Challenge</u>
City: <u>Lyon</u>		State: <u>France</u>	
Track: <u>AZRC Raceway</u>			
Track <input type="checkbox"/> Indoor <input type="checkbox"/> Tight <input type="checkbox"/> Smooth <input checked="" type="checkbox"/> Hard Packed <input type="checkbox"/> Blue Groove <input type="checkbox"/> Wet <input type="checkbox"/> Low Bite <input type="checkbox"/> High Bite Conditions <input checked="" type="checkbox"/> Outdoor <input checked="" type="checkbox"/> Open <input type="checkbox"/> Rough <input type="checkbox"/> Loose/Loamy <input type="checkbox"/> Dry <input type="checkbox"/> Dusty <input checked="" type="checkbox"/> Med Bite <input type="checkbox"/> Other <u>10°C</u>			

Front Suspension

Toe: 2° out

Ride Height: 35 mm

Camber: -2°

Caster: stock

Spindle Height: High Low

Wheel Hex: stock

Sway Bar: 2,3mm

Piston/Oil: 6x1,3mm - 45wt

Shock Type: Bladder Emulsion

Spring: HB red

Limiter/Droop: 115mm

Overall Shock Length: _____

Steering Ackerman: short

Bump Steer: 0mm on spindle - up

Camber Link: 2

Shock Location: 4 - inside

Receiver Battery Type: Dynamite 2000m

Differentials

Front: Standard Smart

Spring Wire Dia. _____

Qty of Springs: _____

Ramp Plate: _____

Grease: _____

Diff Fluid: 15 000 wt

Center: Standard Smart

Spring Wire Dia.: _____

Qty of Springs: _____

Ramp Plate: _____

Grease: _____

Diff Fluid: 30 000 wt

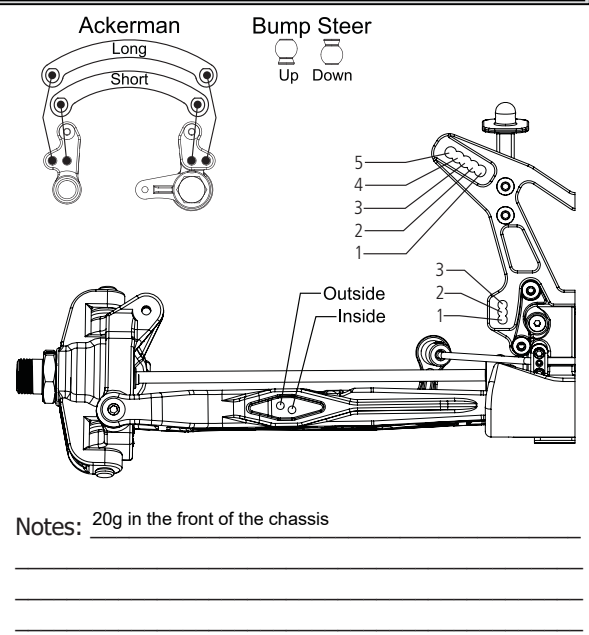

Rear Suspension

Roll Center: HRC LRC

Toe: 3 (0 pill)

Anti-Squat: 1 up pill

Ride Height: 40 mm

Camber: -3°

Rear Hub Spacing: maximum back +2mm

Wheel Hex: stock

Sway Bar: 2,5mm

Piston/Oil: 6x1,3mm - 42.5wt

Shock Type: Bladder Emulsion

Spring: HB red

Limiter/Droop: 127.5 mm

Overall Shock Length: _____

Camber Link: 2 - B

Shock Position: 4 - inside

Rear Diff Fluid: 5 000 wt

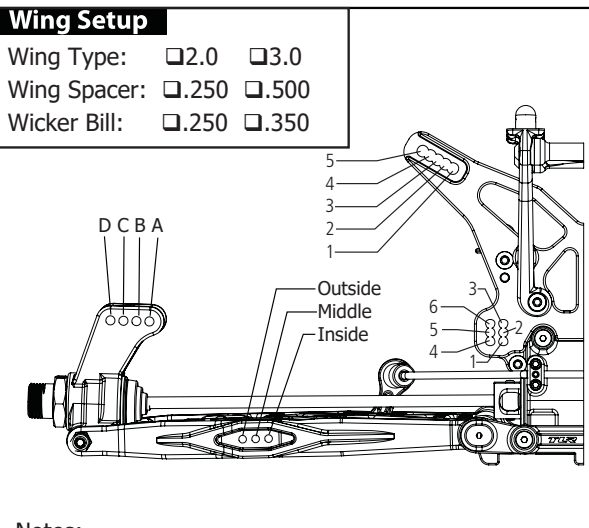

Engine

Engine: RC Concept MC5X Fuel: THOR 25%

Glow Plug: RC4 Head Clearance _____

Pipe/Header: RC Concept 2133 Gearing: 12/51

Clutch Clutch Shoes and Springs Info

4 aluminium shoes with green springs

Tires

Type	Compound	Insert
Front: <u>JC Triple dees</u>	<u>Green</u>	<u>Dirt tech</u>
Rear: <u>JC Triple dees</u>	<u>Green</u>	<u>Dirt tech</u>

Notes: _____

Prototype short chassis