

Name: Frank Root - Standard Clay

Date: August 2019 Event: Clubbin'



City: State:

Track: SDRC, OCRC

Track Dirt Carpet Tight Smooth Hard Packed Dry Grip Level: Low Medium High
Conditions: Clay Astro Turf Open Rough Loamy Wet Tread Level: Pin Ghost Pin Slicks

Front Suspension

Toe: +/- 0 deg Camber: -1.5 deg
Ride Height: 22mm Caster Block: 0° 5°
Kick Shim(s): 2mm 1mm Wedge(20°) Other:
VLA Setting: Short Arm Long Arm
Front Pivot: Alum Composite Brass
Pivot Height: SLRC LRC MRC HRC
Piston: 2 x 1.6 Standard Oil: 32.5wt
Limiters: Internal: - External: - Stroke: 23.5
Shock Eyelet: Std. +2 Shock Location: 2 - Middle
Spring: TLR Green LF Sway Bar: -
Spindle Steering Arm: 4 5 6
Spindle Ball Stud: Standard Low Spacers: -
Draglink Ball Stud: Standard Low Spacers: -
Axle Spacing: 0 +.5mm +1mm
Trail: 2mm 3mm 4mm
Camber Link, Inner: 1 2 3 Outer: A B
Tower: Stiffezel Carbon Carbon +2mm
Mud Guard: Soft Standard Stiffezel
Front Wheels: Standard Stiffezel
Front Wing: Low High Narrow High Wide

Stiffezel Parts:

Front Arm Rear Arm
 Chassis Brace/Waterfall

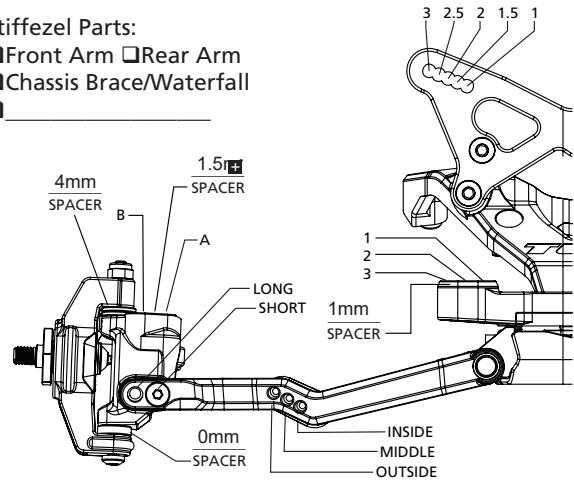

Notes:

Rear Suspension

Configuration: Laydown Standup
Diff. Height: 0 +1 +1.75 +2.5 +3.5
Axle Height: 0 +1 +2 +3 +4
Ride Height: 21mm Camber: -1.5 deg
Hub Spacing: 1.5mm Fr 1.5mm Rr Hex Width: Standard (5.0)
Piston: 1.6/1.7 split Standard Oil: 27.5wt
Spring: TLR LF White Sway Bar: -
Limiters: Internal: - External: - Stroke: 30.75mm
Shock Eyelet: Std. +2 Shock Location: 1.5 - Middle
Shock Mounting: Front Rear Shaft Dia.: 3.0 3.5
Tower: Stiffezel Carbon Carbon +2mm
Camber Block Spacer: 1mm ↓ 0mm 1mm ↑
Camber Link, Inner: 1 2 3
Camber Link, Outer: A B C
Battery Position: 1 2 3 4 5
Wing/Wickerbill: TLR 6.5", 2nd line
Wing Angle: 0° 2° 4° Wing Height: +4mm (RC Lyfe)
Diff Type: Ball Gear Setting: Snug, 3/4 rotation
Gear Diff Gears: Composite Steel Planet Gears: 2 4
Driveshaft Length: CVA Universal Length: 67mm
CV Pin Position: 1 2 3 4
 Direct Drive Slipper Pads: Torque (yel) Drive (org)

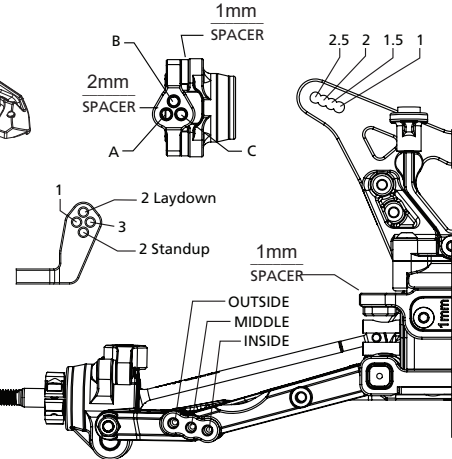
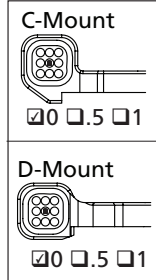
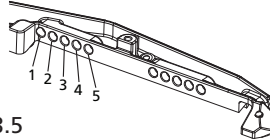
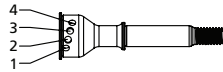

Electronics

Radio: DX6R Timing Advance: 15 Boost
Servo: SPMS6420RX Steering Expo: -
ESC: HW XR10 Pro Throttle/Brake EPA: 100/85
Motor: Motiv MC2 7.5T
Initial Brake: DB Pinion: 21 Spur: 78
Drag Brake: 9% Battery: Motiv Defy G 6000mAh
Throttle Profile: Battery Weight: 205g

Tires

	Front	Rear
Thread:	PL Electron	PL Positron
Compound:	MC	MC
Insert:	Stock	Stock
Sauce:	LW Yellow	LW Yellow

Notes:

Chassis

Electronics Plate
 Brass, 36g
 Carbon

Battery Plate
 19g 26g 37g
Rear Ballast
 16g 25g
C-Pivot Block
 Brass, 20g
 Aluminum
Total Weight: 1575g
FR: % RR: %

